



101D UTILITY GAUGE LOWER MOUNT

1 Utility gauge for commercial and industrial markets
Black steel case, chrome bezel, copper alloy internals

SPECIFICATIONS

Dial	1 1/2" (40 mm), 2" (50 mm), 2 1/2" (63 mm), 3 1/2" (88 mm), 4 1/2" (114 mm)
Case	Black steel, dry non-fillable
Wetted Parts	Copper alloy
Bezel	Chrome plated steel, fixed
Lens	Plastic (4 1/2" = glass lens)
Pointer	Black aluminum
Connection	Lower mount 1 1/2" dial = 1/8" NPT 2" dial = 1/8" or 1/4" NPT 2 1/2" dial = 1/4" NPT 3 1/2" dial = 1/4" NPT 4 1/2" dial = 1/4" NPT
Scale	Standard: psi/BAR (x 100 = kPa) Single scale psi available from stock
Accuracy	3-2-3% of span, ASME B40.1 Grade B
Ambient Temp	-50° F to 160° F

Design meets or exceeds ASME B40.100 pressure gauge standard.

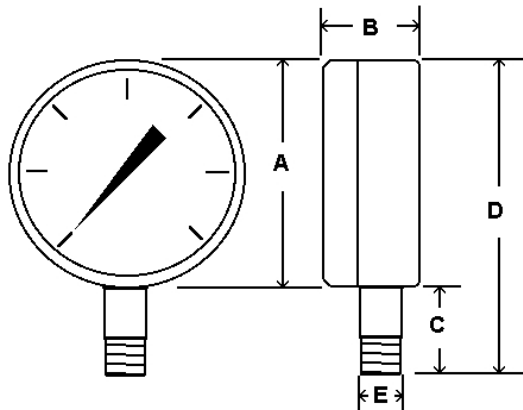

Dial	Unit	A	B	C	D	E
1 1/2"	In.	1.64"	0.93"	0.65"	2.26"	1/8" NPT
	mm	42	24	17	57	
2"	In.	2.07"	1.06"	0.83"	2.83"	1/8" or 1/4" NPT
	mm	53	27	21	72	
2 1/2"	In.	2.5"	1.13"	0.88"	3.31"	1/4" NPT
	mm	63	29	22	84	
3 1/2"	In.	3.54"	1.12"	1.02"	4.49"	1/4" NPT
	mm	90	28	26	114	
4 1/2"	In.	4.79"	1.12"	1.10"	5.8"	1/4" NPT
	mm	122	29	28	147	



AVAILABLE OPTIONS*

- Certificate of Accuracy, NIST traceable
- Custom Dial
- Anti-Vibration Movement, see page 107
- Glass Lens
- Stainless Steel Case
- Cleaned for Oxygen Service
- Special Connection Size
- Protective Rubber Cover, see page 119
- Max/Min Pointer, see page 120

*Lead times/minimums may apply

APPROXIMATE SHIPPING WEIGHTS/ BOX QUANTITIES

Dial Size	Est. Unit Weight	Box Qty
1 1/2"	0.20 lbs (0.10 kg)	200
2"	0.26 lbs (0.12 kg)	100
2 1/2"	0.34 lbs (0.15 kg)	125
3 1/2"	0.50 lbs (0.23 kg)	50
4 1/2"	0.60 lbs (0.27 kg)	50

NOTE: Because of continuing improvements, increments/specifications are subject to change without notice. Stock ranges vary by dial size and configuration. Consult PIC Gauges for availability.