



# 212D REMOVABLE BEZEL CENTER BACK MOUNT

Dry yet fillable gauge with removable bezel, adjustable pointer  
Stainless steel case and bezel, copper alloy internals

## SPECIFICATIONS

2	Dial	2 1/2" (63 mm),
	Case	Stainless steel, dry yet fillable
	Wetted Parts	Copper alloy
	Bezel	Removable, stainless steel
	Lens	Glass
	Pointer	Adjustable, black aluminum
	Connection	Center back mount 2 1/2" dial = 1/4" NPT
	Scale	Standard: psi/BAR (x 100 = kPa)
	Accuracy	2-1-2% of span ASME B40.1 Grade A
	Ambient Temp	Dry = -30° F to 180° F Glycerine Filled = 30° F to 160° F



Design meets or exceeds ASME B40.100 pressure gauge standard.

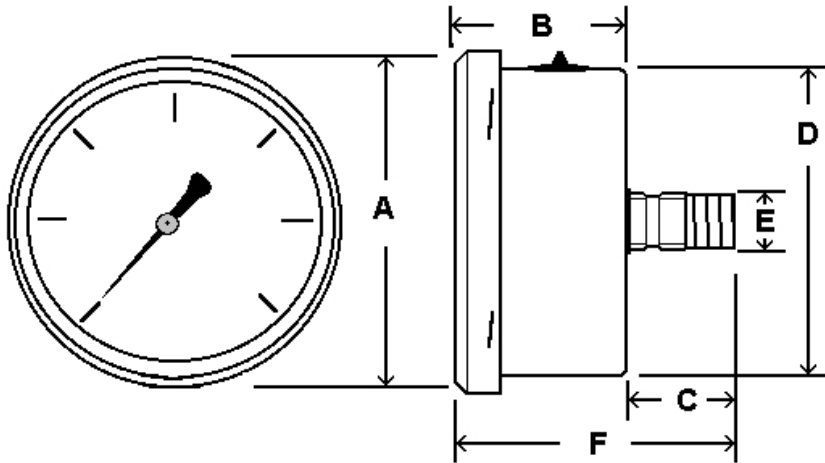

Dial	Unit	A	B	C	D	E	F
2 1/2"	In.	2.83"	1.37"	1.00"	2.49"	1/4"	2.29"
	mm	72	35	25	63	NPT	58

## AVAILABLE OPTIONS\*

- Certificate of Accuracy, NIST traceable
- Custom Dial
- Liquid Fill Options, see page 173
- Anti-Vibration Movement, see page 107
- Cleaned for Oxygen Service (dry only)
- Special Connection Size
- Protective Rubber Cover, see page 119
- Plastic Lens
- Max/Min Pointer, see page 120

\*Lead times/minimums may apply

## APPROXIMATE SHIPPING WEIGHTS/ BOX QUANTITIES

Dial Size	Est. Unit Weight	Box Qty
2 1/2"	0.40 lbs (0.20 kg)	50

NOTE: Because of continuing improvements, increments/specifications are subject to change without notice. Stock ranges vary by dial size and configuration. Consult PIC Gauges for availability.