

# 301LFW ALL STAINLESS LOWER MOUNT



Heavy duty, all stainless steel gauge with welded case-to-stem connection  
 Stainless steel case and bezel, 316 stainless steel internals  
 Glycerine filled for added durability in applications where vibration or pulsation is present

## SPECIFICATIONS

<b>Dial</b>	1 ½" (40 mm), 2" (50 mm), 2 ½" (63 mm), 4" (100 mm) See page 37, 6" (150 mm) - See 6001 page 53
<b>Case</b>	Stainless steel, glycerine filled (available dry) Welded case-to-stem connection
<b>Wetted Parts</b>	316 stainless steel
<b>Bezel</b>	Stainless steel, fixed
<b>Lens</b>	Polycarbonate
<b>Pointer</b>	Black aluminum
<b>Connection</b>	Lower mount 1 ½" dial = ⅛" NPT 2" dial = ⅛" or ¼" NPT 2 ½" dial = ¼" NPT
<b>Scale</b>	Standard: psi/BAR (x 100 = kPa)
<b>Accuracy</b>	3-2-3% of span 1 ½" & 2" ASME B40.1 Grade B 2-1-2% of span 2 ½" ASME B40.1 Grade A
<b>Ambient Temp</b>	Glycerine Filled = 30° F to 160° F Dry = -30° F to 180° F

*Design meets or exceeds ASME B40.100 pressure gauge standard.*

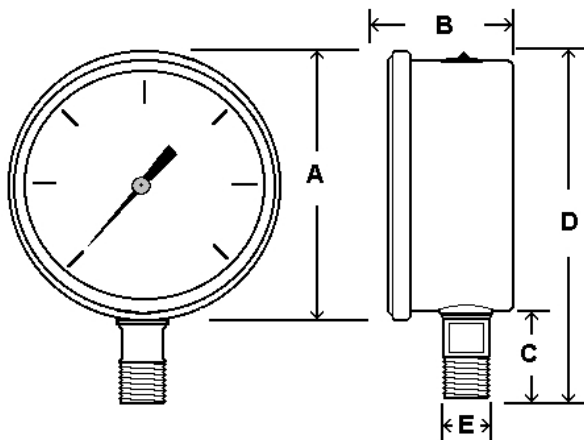

Dial	Unit	A	B	C	D	E
1 ½"	In.	1.84"	1.03"	0.73"	2.32"	⅛" NPT
	mm	47	26	19	59	
2"	In.	2.25"	1.15"	0.91"	2.93"	⅛" or ¼" NPT
	mm	57	30	23	75	
2 ½"	In.	2.70"	1.39"	1"	3.61"	¼" NPT
	mm	69	35	25	92	



3

## AVAILABLE OPTIONS\*

- Certificate of Accuracy, NIST traceable
- Custom Dial
- Liquid Fill Options, see page 173
- Anti-Vibration Movement, see page 107
- Dry, Fillable Case
- Glass Lens
- Cleaned for Oxygen Service (dry only)
- Special Connection Size
- Protective Rubber Cover, see page 119
- Single Scale
- Max/Min Pointer, see page 120

\*Lead times/minimums may apply

## APPROXIMATE SHIPPING WEIGHTS/ BOX QUANTITIES

Dial Size	Est. Unit Weight	Box Qty
1 ½"	0.20 lbs (0.10 kg)	100
2"	0.40 lbs (0.18 kg)	100
2 ½"	0.55 lbs (0.24 kg)	90

NOTE: Because of continuing improvements, increments/specifications are subject to change without notice. Stock ranges vary by dial size and configuration. Consult PIC Gauges for availability.