

# 6001 6" ALL STAINLESS LOWER MOUNT



Heavy duty, all stainless steel gauge with removable bezel, adjustable pointer  
1% accuracy, welded case-to-stem connection, dry yet fillable

## SPECIFICATIONS

<b>Dial</b>	6" (150 mm)
<b>Case</b>	Stainless steel, dry yet fillable Welded case-to-stem connection
<b>Wetted Parts</b>	316 stainless steel
<b>Movement</b>	With overload/underload stops
<b>Bezel</b>	Removable, stainless steel
<b>Lens</b>	Laminated safety glass
<b>Pointer</b>	Micro adjustable, black aluminum
<b>Connection</b>	Lower mount 1/4" or 1/2" NPT
<b>Scale</b>	Standard: single scale psi
<b>Accuracy</b>	1% of span ASME B40.1 Grade 1A
<b>Ambient Temp</b>	Dry = -30° F to 180° F Glycerine Filled = 30° F to 160° F

Design meets or exceeds ASME B40.100 pressure gauge standard.

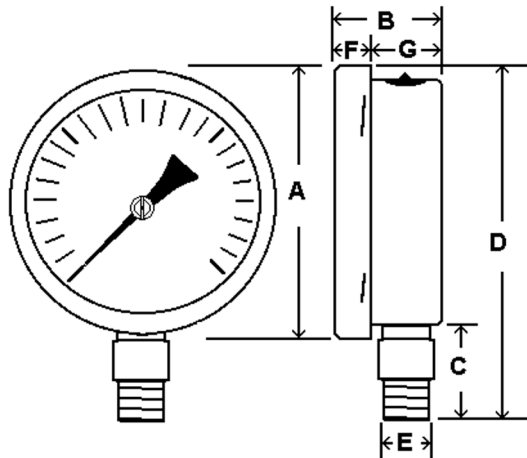

Dial	Unit	A	B	C	D	E	F	G
6"	In.	6.75"	2.05"	1.50"	8.41"	1/4" or 1/2" NPT	0.73"	1.27"
	mm	172	52	38	214		18	32

## AVAILABLE OPTIONS\*

- Certificate of Accuracy, NIST traceable
- Custom Dial
- Liquid Fill Options, see page 173
- Special Connection Size
- Cleaned for Oxygen Service (dry only)
- Polycarbonate Lens

\*Lead times/minimums may apply

## APPROXIMATE SHIPPING WEIGHTS/ BOX QUANTITIES

Dial Size	Est. Unit Wt.	Box Qty
6"	2.15 lbs (0.98 kg)	10

NOTE: Because of continuing improvements, increments/specifications are subject to change without notice. Stock ranges vary by dial size and configuration. Consult PIC Gauges for availability.