



# PRO-201L LIQUID FILLED LOWER MOUNT

Improved accuracy to ASME B40.1 Grade A. One piece design for toughness during installation. Glycerin filled for added durability during in application. Stainless steel case and bezel with copper alloy internals.

2

<b>Dial</b>	2 ½" (63 mm)
<b>Case</b>	Stainless steel, glycerine filled
<b>Wetted Parts</b>	Copper alloy
<b>Bezel</b>	Stainless steel, fixed
<b>Lens</b>	Polycarbonate
<b>Pointer</b>	Black aluminum
<b>Connection</b>	Lower mount 2 ½" dial = ¼" NPT
<b>Scale</b>	Standard: psi/BAR (x 100 = kPa)
<b>Accuracy</b>	2-1-2% of span ASME B40.1 Grade A
<b>Ambient Temp</b>	Glycerine Filled = 30° F to 160° F Dry = -30° F to 180° F

Design meets or exceeds ASME B40.100 pressure gauge standard.

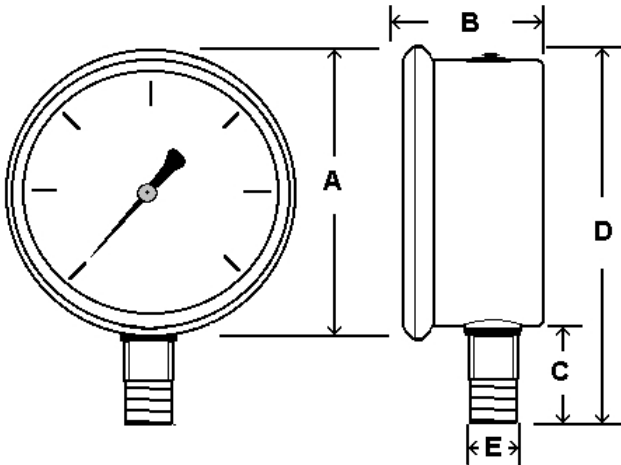

Dial	Unit	A	B	C	D	E
2 ½"	In.	2.65"	1.20"	0.88"	3.30"	¼" NPT
	mm	68	30	22	84	

- Certificate of Accuracy, NIST traceable
- Custom Dial
- Liquid Fill Options, see page 180
- Anti-Vibration Movement, see page 113
- Dry, Fillable Case
- Special Connection Size
- Protective Rubber Cover, see page 125
- Max/Min Pointer, see page 126

\*Lead times/minimums may apply

Dial Size	Est. Unit Weight	Box Qty
2 ½"	0.45 lbs (0.20 kg)	100

NOTE: Because of continuing improvements, increments/specifications are subject to change without notice. Stock ranges vary by dial size and configuration. Consult PIC Gauges for availability.