

PRO-204L LIQUID FILLED FRONT FLANGE PANEL MOUNT



Improved accuracy to ASME B40.1 Grade A. One piece design for toughness during installation. Glycerin filled for added durability during in application. Stainless steel case and bezel with copper alloy internals.

Dial	2 1/2" (63 mm)
Case	Stainless steel, glycerine filled
Wetted Parts	Copper alloy
Bezel	Stainless steel, fixed
Lens	Polycarbonate
Pointer	Black aluminum
Connection	Center back mount with front flange 2 1/2" dial = 1/4" NPT
Scale	Standard: psi/BAR (x 100 = kPa)
Accuracy	2-1-2% of span ASME B40.1 Grade A
Ambient Temp	Glycerine Filled = 30° F to 160° F Dry = -30° F to 180° F



2

Design meets or exceeds ASME B40.100 pressure gauge standard.

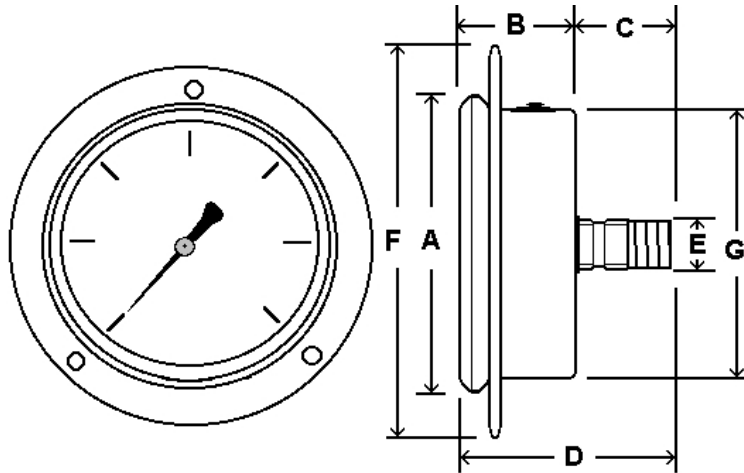

- Certificate of Accuracy, NIST traceable
- Custom Dial
- Liquid Fill Options, see page 180
- Anti-Vibration Movement, see page 113
- Dry, Fillable Case
- Special Connection Size
- Max/Min Pointer, see page 126

*Lead times/minimums may apply

Dial	Unit	A	B	C	D	E	F	G
2 1/2"	In.	2.65"	1.21"	0.91"	2.12"	1/4"	3.46"	2.44"
	mm	68	31	23	54	NPT	88	61

For complete flange dimensions, see page 127.

Dial Size	Est. Unit Weight	Box Qty
2 1/2"	0.55 lbs (0.26 kg)	60

NOTE: Because of continuing improvements, increments/specifications are subject to change without notice. Stock ranges vary by dial size and configuration. Consult PIC Gauges for availability.