



SE-102D UTILITY GAUGE CENTER BACK MOUNT

**1 Utility gauge for commercial and industrial markets
Black steel case and bezel, copper alloy internals**

SPECIFICATIONS

Dial	1 1/2" (40 mm), 2" (50 mm), 2 1/2" (63 mm)
Case	Black steel, dry non-fillable
Wetted Parts	Copper alloy
Bezel	Black painted steel, fixed
Lens	Glass
Pointer	Black aluminum
Connection	Center back mount 1 1/2" dial = 1/8" NPT 2" dial = 1/8" or 1/4" NPT 2 1/2" dial = 1/4" NPT
Scale	Standard: psi/BAR (x 100 = kPa)
Accuracy	3-2-3% of span, ASME B40.1 Grade B
Ambient Temp	-50° F to 160° F

Design meets or exceeds ASME B40.100 pressure gauge standard.

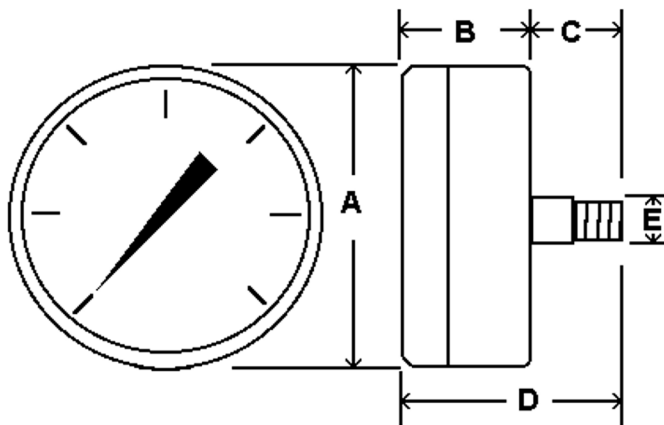

Dial	Unit	A	B	C	D	E
1 1/2"	In.	1.64"	0.93"	0.63"	1.54"	1/8" NPT
	mm	42	24	16	39	
2"	In.	2.07"	1.03"	0.83"	1.86"	1/8" or 1/4" NPT
	mm	53	26	21	47	
2 1/2"	In.	2.5"	1.17"	0.90"	1.97"	1/4" NPT
	mm	63	30	23	50	

AVAILABLE OPTIONS*

- Certificate of Accuracy, NIST traceable
- Custom Dial
- Anti-Vibration Movement, see page 107
- Cleaned for Oxygen Service
- Special Connection Size
- Protective Rubber Cover, see page 119
- Plastic Lens
- Max/Min Pointer, see page 120

*Lead times/minimums may apply

APPROXIMATE SHIPPING WEIGHTS/ BOX QUANTITIES

Dial Size	Est. Unit Weight	Box Qty
1 1/2"	0.15 lbs (0.06 kg)	100
2"	0.25 lbs (0.10 kg)	100
2 1/2"	0.37 lbs (0.17 kg)	100

NOTE: Because of continuing improvements, increments/specifications are subject to change without notice. Stock ranges vary by dial size and configuration. Consult PIC Gauges for availability.