

# SEP-102D UTILITY GAUGE ABS PLASTIC CASE



**ABS plastic case utility gauge for commercial and industrial markets**  
**Black plastic case, copper alloy internals**

## SPECIFICATIONS

|                     |  |
|---------------------|--|
| <b>Dial</b>         | 2" (50 mm)                               |
| <b>Case</b>         | ABS plastic, dry non-fillable            |
| <b>Wetted Parts</b> | Copper alloy                             |
| <b>Lens</b>         | Plastic                                  |
| <b>Pointer</b>      | Black aluminum                           |
| <b>Connection</b>   | Center back mount<br>2" dials = 1/4" NPT |
| <b>Scale</b>        | Standard: psi/BAR (x 100 = kPa)          |
| <b>Accuracy</b>     | 3-2-3% of span, ASME B40.1 Grade B       |
| <b>Ambient Temp</b> | -40° F to 140° F                         |

*Design meets or exceeds ASME B40.100 pressure gauge standard.*

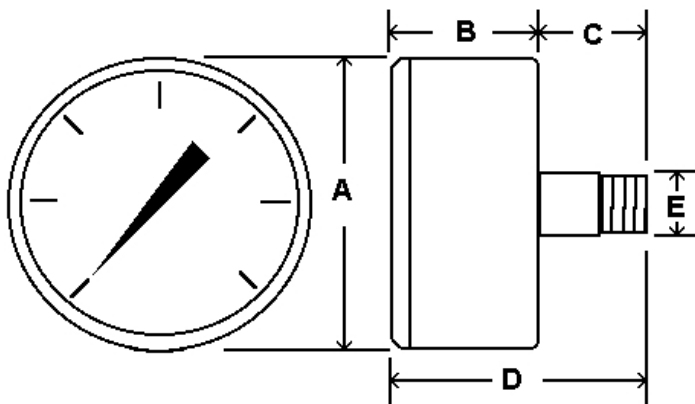

| Dial | Unit | A     | B     | C     | D     | E        |
|------|------|-------|-------|-------|-------|----------|
| 2"   | In.  | 2.11" | 1.06" | 0.71" | 1.77" | 1/4" NPT |
|      | mm   | 54    | 27    | 18    | 45    |          |

## AVAILABLE OPTIONS\*

- Certificate of Accuracy, NIST traceable
- Custom Dial
- Anti-Vibration Movement, see page 107
- Cleaned for Oxygen Service
- Special Connection Size
- Protective Rubber Cover, see page 119
- Max/Min Pointer, see page 120

\*Lead times/minimums may apply

## APPROXIMATE SHIPPING WEIGHTS/ BOX QUANTITIES

| Dial Size | Est. Unit Weight      | Box Qty |
|-----------|-----------------------|---------|
| 2"        | 0.20 lbs<br>(0.08 kg) | 100     |

NOTE: Because of continuing improvements, increments/specifications are subject to change without notice. Stock ranges vary by dial size and configuration. Consult PIC Gauges for availability.